



MOODY
Bible Institute™



PARENTS' GUIDE

2016-2017

Dear parent,

I'd like to extend a warm Moody Bible Institute welcome to you! We are honored that you have entrusted your child to us for spiritual training.

There is no place quite like Moody. After 130 years of equipping more than 42,000 alumni to serve Christ in 109 countries, Moody has earned a reputation as one of the finest Bible colleges in the world. My wife, Cheryl, and I believed that even before I began serving as president—three of our children are Moody graduates.



Both as a parent and an employee, I have witnessed the professional excellence and authentic faith of Moody's faculty and staff. They will help your student prepare for ministry with strong biblical teaching, practical ministry training, and a supportive, prayerful community.

We look forward to serving and guiding your student in the years to come.

Yours in Christ,

J. Paul Nyquist, Ph.D.
President

Telephone Directory 4

Academic Calendar 6

Music Ensemble Tours 6

Campus Location 7

Campus Map and Parking 8

Services for Parents 9

Getting Settled on Campus 10

Career and Employment Opportunities 11

Hotel Accommodations 12

Prayer Guide for Parents 13

Glossary of Terms 15

Tips for Parents 17

Gift Card/Care Package 18

Moody Family Weekend



SEPTEMBER 23-24, 2016

Only \$25 per family.

Pre-register or learn more at moody.edu/familyweekend.

Pre-registration required by September 16, 2016.



ACADEMIC ADMINISTRATION

- (312) 329-4112 President, Dr. Paul Nyquist
- (312) 329-4113 Provost and Dean of Education, Dr. Junias Venugopal
(Undergraduate, Seminary, Distance Learning, Student Life, and Enrollment Services)
- (312) 329-4005 Associate Provost of Faculty, Dr. Larry Davidhizar
- (312) 329-4070 Vice President and Dean of Undergraduate School, Dr. James Spencer
(Undergraduate School)
- (312) 329-4044 Faculty Reception Desk
(Communication link to faculty members)
- (312) 329-4129 Vice President and Dean of Moody Theological Seminary, Dr. John Jelinek
(Moody Theological Seminary [MTS])

ACADEMIC CONCERNS

- (312) 329-4268 Registrar/Director of Academic Records, Mr. George Mosher
- (312) 329-2087 Academic Records *(class schedules, registration, and transcripts)*
- (312) 329-2022 Vice President and Dean of Student Enrollment Services, Mr. Anthony Turner
(prospective student visits and information)
- (312) 329-4118 Practical Christian Ministry *(students' weekly ministries)*
- (312) 329-4116 Chair of Field Education (PCM), Mr. Don Martindell

CAMPUS CONCERNS

- (312) 329-4252 Campus Post Office *(student mail and packages)*
- (312) 329-4324 Food Service *(meal plan, meals, banquets, and care packages)*
- (312) 329-4404 Event and Guest Services *(campus tour, Institute-wide events, and discounts at local hotels)*
- (312) 329-4357 Public Safety *(campus security)*
- (312) 329-4314 Facilities *(student and employee parking)*

EMPLOYMENT

- (312) 329-4237 Human Resources *(on-campus employment)*
- (312) 329-4414 Student Employment and Career Development *(off-campus employment; see page 11)*

FINANCIAL AID

- (312) 329-4272 Director of Financial Aid, Mrs. Heather Shalley
- (312) 329-4254 Financial Aid Counselor, Ms. Zerreka Lloyd
- (312) 329-4178 Financial Aid General Inquiries, Mr. Tim Krug
- (312) 329-4165 Financial Aid Counselor, Ms. Eugenia Jones
- (312) 329-4271 Financial Aid Counselor, Mr. Frank Slomkowski III

STUDENT DEVELOPMENT

- (312) 329-4193 Student Development
- (312) 329-4191 Vice President and Dean of Student Life, Dr. Timothy Arens
(student life programs) C: (708) 220-4520
- (312) 329-4106 Associate Dean of Students, Rachel Monfette
- (312) 329-4202 Associate Dean for Student Programs, Mr. Joe Gonzales
(student activities and the Alumni Student Center) H: (630) 783-9642
- (312) 329-4192 Associate Dean of Residence Life, Dr. Bruce Norquist
(residence life and student housing) C: (630) 456-8617
- (312) 329-4199 Assistant Dean for International Students
(international student and missionary kid needs)
- (312) 329-4194 Associate Dean for Counseling Services, Mr. Steve Brasel
(private and group counseling services) H: (219) 374-7155
- (312) 329-2177 Assistant Dean for the Student Resource Center, Mrs. Gayla Gates
(assistance with academic issues and peer tutoring)
- (312) 329-4417 Administrator of Health Service, Ms. Ann Meyer
(doctor appointments, tests, and inoculations) C: (630) 273-1215
- (312) 329-4321 Department Manager of Food Service, Mr. Greg Dickson

RESIDENCE HALL RECEPTION DESKS

- (312) 329-4201 Houghton Hall (24/7)
- (312) 329-4209 Culbertson Hall (24/7)
- (312) 329-3200 Dryer Hall (12 midnight–6 a.m.)

STUDENT ACCOUNTS

- (312) 329-4368 Student Bookkeeper *(student accounts: room/board, fees, and bookstore charges)*
- (312) 329-4212 Payment Plan *(monthly payment plan for students' school bills)*
- (312) 329-4367 Health Insurance *(student insurance needs and waiver instructions)*

academic calendar

FALL 2016

August

17	Residence Halls open at 8:00 a.m.
17-21	Orientation and registration of new and former students
20-21	Continuing students return
22	First day of classes
23	Opening Convocation, 10:00 a.m.

September

5	Labor Day holiday
---	-------------------

October

11-14	Missions Conference
17-18	Study/reading days

November

8-10	Spiritual Enrichment Week
23-27	Thanksgiving recess
28	Classes resume

December

8	Last day of classes
9	Study/reading day
12-15	Final examinations

SPRING 2017

January

5	Residence Halls open at 8:00 a.m.
5-8	Orientation and registration of new and former students
7-8	Continuing students return
9	First day of classes
16	Martin Luther King Jr. Day holiday

February

6-10	Founder's Week Conference
------	---------------------------

March

1	Day of prayer
11-26	Spring recess
27	Classes resume

April

14	Good Friday holiday
----	---------------------

May

5	Last day of classes
8	Study/reading day
9-12	Final examinations
13	Commencement

For information on athletic events, visit moody.edu/athletics.

2017 music ensemble tours

Music Ensemble	Conductor	Winter Tour January 13-16	Spring Tour March 3-17
Moody Chorale	Dr. Xiangtang Hong	Wisconsin/Minnesota	Western Canada
Men's Collegiate Choir	Dr. H. E. Singley	Michigan	Rocky Mountain USA
Symphonic Band	Mr. David Gauger	Illinois/Missouri/Iowa	Northeast USA
Women's Concert Choir	Dr. Betty-Ann Lynerd	Indiana/Ohio	North Central USA

Messiah Concert: November 13, 2016

Candlelight Carols: December 2-3, 2016

campus location

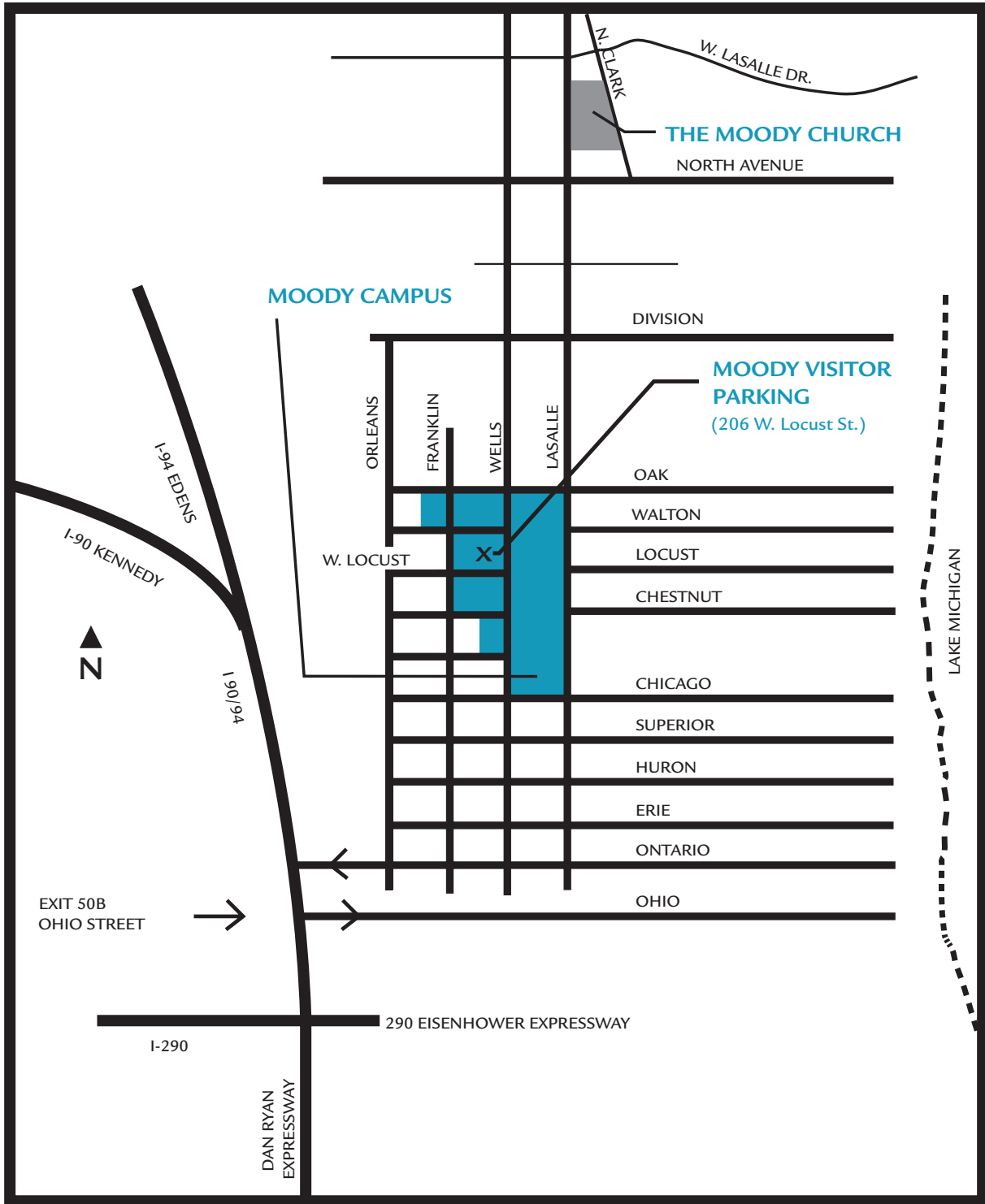

campus map and parking

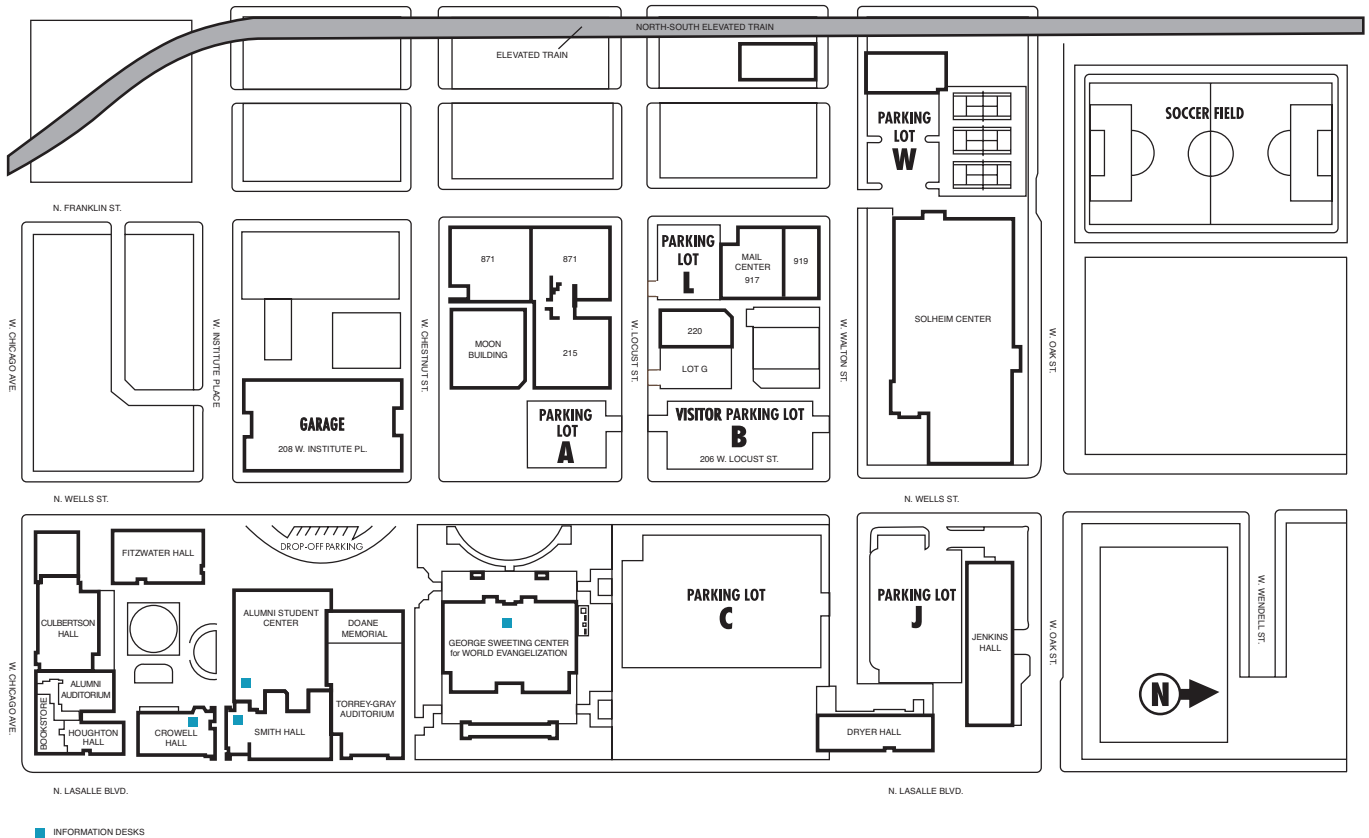

PARKING

On a downtown urban campus, parking is always at a premium. However, there are several options for you to consider when visiting Moody's campus.

Moody Visitor Parking Lot B

- The visitor parking lot is located at 206 W. Locust St. (corner of N. Wells), three blocks north of Chicago Ave.
- Free parking is available from 6 a.m.–midnight, with a guest parking permit, when visiting the campus.
- Please stop by the Alumni Student Center desk (enter under the clock tower) to receive a parking permit.
- If you arrive outside of the above stated hours, visit the Crowell Hall desk to receive a parking permit.

Alumni Student Center Circle Drive Lot

A limited number of 15-minute parking spots for drop-off and pick-up are available in the circle driveway at the Alumni Student Center, located at 821 N. Wells.

For more parking instructions or information, please contact Facilities at (312) 329-2208.

PARENT ASSOCIATION

moody.edu/parents

Once your student becomes enrolled at Moody Bible Institute, you as parents are “enrolled” in the Moody Parent Association.

Ways to be involved in the Parent Association:

1. “Like” Moody Parent Association on Facebook to stay informed about upcoming events and campus life.
2. Attend the parent orientation and reception on Wednesday, August 17, 2016, starting at 2 p.m.
3. Attend Family Weekend, September 23–24, 2016 (see ad on page 3).

Each summer, invitations are sent to parents of new students to invite them to be part of the Parent Council. The Parent Council is made up of parents of students from all over the U.S. and/or Canada and serves as a conduit for strengthening communication between parents and the Moody community. Through communication, education, and activities, the Parent Council equips parents to provide support to students, other parents, and Moody.

If you would like to contact our current Parent Council members to ask questions about Moody life as a parent or to find out what it is like to serve on the Parent Council, feel free to contact one of the Parent Council couples below.

Council Members	State	Email
Jeff & Tamra Barbieri	Michigan	tbarbieri5@gmail.com
Pete & Sunnie Frank	Indiana	pfrank@gospelink.org
Jeanne Heaton	Illinois	811jeanne@gmail.com
Craig & Janel Prichard	Illinois	cjprich@yahoo.com
Peter & Lisa Stueckemann	Georgia	lisa.stueckemann@comcast.net
Fred & Janna Youngen	Indiana	jlyoungen@att.net

MOODY STEWARDSHIP DEPARTMENT

moodyglobal.org/donate/planned-giving

Moody has a long-established Planned Giving program and can help those who desire to remember Moody in their estate plan by way of a legacy gift. Please contact us if you would like to learn more about Planned Giving options.

TODAY IN THE WORD

todayintheword.com

This is the devotional publication of Moody that offers supporters and friends a daily study exploring the timeless truth of Scripture while making timely application to life in today’s world. *Today in the Word* is available in print and online.

AREA STORES

Aldi (driving)

- From Moody, go north on Wells St.
- Turn west (left) onto North Ave.
- Turn right onto Clybourn Ave.
- 1836 N. Clybourn Ave., (855) 955-2534

Bed Bath and Beyond (walking or driving)

- From Moody, go east on Chicago Ave.
- Turn south (right) onto State St.
- Bed Bath and Beyond is on the north (right) side of the street at the corner of State and Grand
- 530 N. State St., (312) 755-9890

The Container Store (driving)

- From Moody, go north on Wells St.
- Turn west (left) onto North Ave.
- The Container Store is on the right after you pass the intersection of North and Clybourn Ave.
- 908 W. North Ave., (312) 654-8450

Jewel-Osco (walking or driving)

- From Moody, go north on LaSalle Blvd.
- Turn west (left) onto Division St.
- Jewel is on the north (right) side of the street at the corner of Division and Sedgwick St.
- 424 W. Division St., (312) 642-2709

Plum Market (walking or driving)

- From Moody, go north on Wells St.
- Continue past Division St.
- Plum Market is on the right
- 1233 N. Wells St., (312) 229-1400

REI (driving)

- From Moody, go north on LaSalle Blvd.
- Turn west (left) onto Division St.
- Turn north (right) onto Halsted St.
- 1466 N. Halsted St., (312) 951-6020

Target (walking or driving)

- From Moody, go north on Wells St.
- Turn west (left) onto Division St.
- Turn north (right) onto Larrabee St.
- Target will be on the left
- 1200 N. Larrabee St., (312) 470-8944

Trader Joe's (driving)

- From Moody, go north on Wells St.
- Turn west (left) onto North Ave.
- Turn right onto Clybourn Ave.
- 1840 N. Clybourn Ave., (312) 274-9733

Walgreens (walking or driving)

- From Moody, go one block west on Chicago Ave.
- Walgreens is just past the "L" tracks on the left side of the street
- 315 W. Chicago Ave., (312) 280-1599

For more locations, visit walgreens.com and select *Store Locator*.

Whole Foods Market (walking or driving)

- From Moody, go south on LaSalle Blvd.
- Turn left onto W. Huron St.
- Whole Foods Market is on the left
- 30 W. Huron St., (312) 932-9600

AREA BANKS

Treasury Operations is located on the fourth floor of Crowell Hall. Tellers are available 9 a.m.–2:30 p.m. (closed from noon until 1 p.m. for lunch), Monday through Friday. Students may cash U.S. personal checks for amounts up to \$50.00 provided financial obligations to the Institute are in satisfactory condition. Checks should be made payable to the individual cashing the check. Moody student payroll checks may be cashed at the teller's window.

A list of area banks is shown below.

Chase Bank

chase.com

- 71 W. Chicago Ave., Chicago, IL 60654, (312) 337-0411
- 1122 N. Clark St., Chicago, IL 60610, (312) 573-3977
- Hancock Tower—875 N. Michigan Ave., Chicago, IL 60611, (312) 664-4600

Credit Union One

creditunion1.org

- Tribune Tower—435 N. Michigan Ave., Suite 919, Chicago, IL 60611, (312) 836-9910
- James R. Thompson Center—100 W. Randolph, Suite 208, Chicago, IL 60601, (312) 782-7929

career and employment opportunities

CAREER DEVELOPMENT CENTER

moody.edu/careerdevelopment

Associate Dean: Patrick Friedline
(312) 329-4414 or patrick.friedline@moody.edu

Moody's Career Development Center offers a variety of services to students and alumni, including the following:

Career Counseling and Assessments: Helps students and alumni decide what to do and where to do it, through individual counseling and assessment tools.

Ministry Search Strategies: Teaches students and alumni to network with friends and home church contacts as well as to utilize the CDC's Career Finder tool. This is an online job board with both full-time and part-time job opportunities. Spouses of students and alumni may use Career Finders by having their spouse register and login for them.

Job Search Skills: Provides insight into career, position, and organization research, résumé and cover letter preparation, job interviews, realistic expectations, and more.

Graduate School Counseling: Guides students in choosing and applying to graduate schools and seminaries, including financing, GRE preparation, and application advice.

Ongoing Alumni Services: Offers ongoing help, ideas, and support to any alumni seeking to transition into new positions. The CDC is just a phone call or email away!

STUDENT EMPLOYMENT OFFICE (PART-TIME OFF-CAMPUS JOBS)

Over the years, students from Moody have developed an excellent reputation in the surrounding neighborhoods as trustworthy and hardworking employees. We receive calls each day from individuals wanting to employ Moody students. Listings of available jobs are found on the "Chicago Campus" tab of your student's my.moody.edu student portal, under "Student Employment Services."

There are several guidelines for students working off-campus. For questions or a pamphlet describing the stipulations, please visit, call, or email Patrick Friedline in the Career Development Center.

hotel accommodations

Parents are invited to take advantage of discounted hotel rates when coming to Chicago to visit their students at Moody. For updated hotel information, please visit moody.edu/chicago/accommodations. For reservations, please contact the hotel of your choice directly and ask for the special Moody rate.



ACME HOTEL

15 E. Ohio St., Chicago, IL 60610
acmehotelcompany.com · (312) 894-0900

This beautifully restored 1920s building features art deco decor and is eight blocks from Moody's campus. Your rate includes complimentary high-speed Internet.



BEST WESTERN RIVER NORTH

125 W. Ohio St., Chicago, IL 60654
rivernorthhotel.com · (312) 467-0800 or (800) 727-0800

This family-style hotel is located just five blocks south of Moody in the heart of the River North district. The Best Western features an indoor pool, fitness center, sun deck, complimentary parking with in/out privileges, and complimentary breakfast for two.



HOLIDAY INN MART PLAZA

350 W. Mart Center Dr., Chicago, IL 60654
martplaza.com · (312) 836-5000

This large convention hotel is located in Chicago's Merchandise Mart, one of the nation's busiest trade centers. Guests may enjoy the indoor pool and exercise facility. Complimentary coffee, tea, and continental breakfast is provided in the reception room each morning.



HOTEL INDIGO

1244 N. Dearborn Pkwy., Chicago, IL 60610
ihg.com · (312) 787-4980

This lifestyle hotel is eight blocks from Moody in a quaint historic neighborhood. Your rate includes use of an extensive health and fitness center, free morning newspaper, cable/satellite TV, CD player, Internet connection, and a coffee/tea maker.

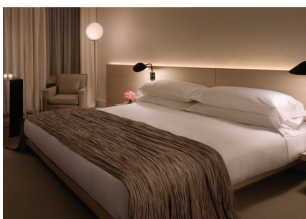

PUBLIC CHICAGO

1301 N. State Pkwy., Chicago, IL 60610
publichotels.com · (312) 787-3700 or (888) 506-3471

An innovative, chic, authentic-style hotel less than a mile from Moody, Public features the re-imagined Pump Room, with a new food concept by James Beard award winning Chef Jean-Georges Vongerichten.



RESIDENCE INN BY MARRIOTT

201 E. Walton Pl., Chicago, IL 60611
marriott.com · (312) 943-9800

Spacious studio, one-bedroom, and two-bedroom suites feature all the amenities of a "home away from home." Your rate includes a hot breakfast buffet, complimentary social hour (Monday through Thursday), Wednesday dinner buffet, coffee/tea, fully equipped kitchen, and furnished living room.

prayer guide for parents

As you spend time in prayer for your student, here are some prayer requests to consider.

Freshmen: That their roots in Christ will grow deep. That being on a Christian campus, they will not set their personal spiritual feeding on auto-pilot. That selfish tendencies will instead become focused on God and others. That they will be solid in the Christian worldview, knowing why they believe what they believe.



President and Executive Leaders: That the men and women who have been chosen by God to lead Moody would clearly hear His voice and guidance throughout this year. That they will be a team united in spirit and focused on furthering Moody's goal to equip young people to make a Christian difference in this world.

Campus Organizations: That they will have clear purposes and focuses. That specific goals will be set and efficiently fulfilled. That they will be service-oriented for God's glory.

Homework: That students will quickly develop disciplined study habits. That they will resist procrastination. That they will develop good writing skills, producing quality papers on time. That they will enjoy learning.

Roommates: That students will thoughtfully put the needs and feelings of their roommates above their own. That differences and frustrations will be worked out in a mature and respectful manner. That they will be positive influences on each other.

Chapel Services: That the services will be carefully and prayerfully planned. That they will be meaningful, challenging, and anointed by God's Spirit. That the students will anticipate chapel services as highlights.

Faculty: That interaction with the students will continue beyond the classroom, projecting a spirit of genuine caring. That their personal lives will exemplify Christ. That all of their teaching will be grounded in Scripture. That they will be sensitive to students with special needs, seeking ways to provide help or a listening ear. That they will translate ideas and theories into practical Christian living. That they will mentor or disciple eager students.

Sophomores: That as they struggle with life's key issues, they will have clarity of mind and a submissive heart to do what is right. That they will be protected from Satan's deceit. That they will seek God's will for their future careers. That they will have steadfast walks with God.

Student Ministries: That the right combination of students will be placed on ministry teams. That thoughtfulness and understanding will create a harmonious bond. That they will have steadfast walks with God.

Student Development Staff: That they will be positive examples to the students under their care. That they will have extra measures of maturity and wisdom in dealing with issues that arise.

Athletics: That athletes will be mindful they are representing Moody for Christ and will conduct themselves accordingly. That dignity and respect will be the code of coaches toward their players and of players toward opponents.



Safety: That all will be safe during school events and activities. That students will be protected in travel to and from home and other outings.

Entertainment: That students will have fun while maintaining a positive, Christ-like attitude.

Student Finances: That God will provide needed funds for school bills. That when students earn money, they will handle it responsibly.

All Students: That they will have a passion for God's Word. That if marriage is to be a part of their futures, they will discover the spouses that are God's best for them in His time. That they will have enough hardships to keep them humble and enough successes to affirm their walk with God. That when doubt comes, convincing and satisfying answers will be found.

Administration: That all of their dealings will be marked with integrity. That daily decision-making will be shaped by the mind of Christ. That they will always strive to enhance the students' spiritual welfare.

Married Students: That school pressures will not create stress in their marriages. That they will develop mature communication skills for working out differences. That they will live disciplined lifestyles. That they will have strong commitments to one another in Christ-centered marriages.

Student Newspaper: That the editorial staff will strive for excellence. That the newspaper content will be edifying. That secular worldviews would be challenged. That students will be guided by faculty sponsors in discerning what is appropriate to publish.

Juniors: That while their head knowledge increases, their heart faith will not decrease. That they will select the most beneficial classes for their personal growth and ministry. That they will develop lifestyles pleasing to God.

Support Staff: That they will be keenly aware of their importance to Moody. That they will have joyful spirits in their work. That they will reach out to students. That if they are a supervisor to students, they will hold high a quality work ethic and accountability.

Moody's Financial Needs: That supporters will be generous in their giving. That funds will be wisely and efficiently spent. That more scholarships will become available and that they will be dispersed to the right students. That the year will end "in the black."

Dating Relationships: That students will uphold biblical standards, maintaining purity in thoughts and actions. That faculty and students alike will have the courage to lovingly confront any relationship obviously off track.

International Students: That they will experience smooth transitions to a new culture. That American students will embrace international students with wholehearted acceptance.



Seniors: That God will go before them in preparing future ministry and job opportunities. That they will evaluate decisions and opportunities from an eternal perspective. That they will have inner strength to stand (even alone, if necessary) for what is right.

Mealtimes: That students will be grateful for plentiful food. That they will not complain. That table conversations will be times of bonding and encouragement.

Parents of Students: That they will faithfully pray for their children. That they will discern when to give counsel and when to remain silent. That their advice will be sound and insightful.

Local Community: That Moody will maintain respect from the community because of its ethical integrity and genuine interest in people as individuals. That Moody will be an attractive spiritual light to the area. That Moody will creatively minister within the community.

From time to time, when your son or daughter calls or writes home, you may hear terms that sound somewhat like a foreign language. To assist you in communicating with your student, we've included the following glossary of terms that are more or less unique to the Moody experience.

Alumni Auditorium: The smaller of two campus auditoriums, where freshmen attend their required Old Testament and New Testament Survey courses.

Alumni Student Center (ASC): The newest facility built on campus, it is designed to encourage unity and fellowship. Facilities include study/social areas, game room, activity room, commuter locker room, student organization offices, and a coffee kiosk (Joe's).



The Arch: Moody's famous pathway from the inner campus to LaSalle Boulevard, after which the student yearbook, *The Arch*, and the varsity athletic teams (Archers/Lady Archers) have been named.

Bro/Sis: Each women's residence hall wing has a corresponding men's residence hall floor. Bro/Sis floors gather together for socially and spiritually enriching activities, and commonly sit together at meal and chapel times.

The Calling: A men's ministry focused on fostering authentic and Christ-centered community across campus through small groups and discipleship relationships.

Candlelight Carols: An annual Christmas program presented by the four music groups of Moody: the Women's Concert Choir, the Men's Collegiate Choir, the Moody Symphonic Band, and the Moody Chorale. Many hours of preparation are invested by the students involved in this top-quality performance.

Care Basket: A service provided by Food Service whereby the parents or loved ones of a student can purchase a basket of goodies and have it delivered to the student. Call Food Service for more information at (312) 329-4324.

CPO: Campus Post Office, Moody's fully-equipped postal service on campus.

Culby: Nickname used for Culbertson Hall, the larger of two men's residence halls.

Doane: The Doane Memorial Music Building houses the Music Department faculty, various music classes, and practice rooms for students.

Dryer: Dryer Hall, the smaller of two men's residence halls.

Embrace: A student organization designed to involve, support, and minister to the African-American students on campus, and to promote multicultural sensitivity throughout the Moody community.

Gino's East/Giordano's/Lou Malnati's: Local restaurants that serve Chicago's famous stuffed pizza.

Houghton: Houghton Hall, a women's residence hall.

Informal: A live variety show that allows students to display their talents and skills through popular performance styles and technical support.

Jenkins: Jenkins Hall, a residence hall for married and graduate students as well as some upper-class women.

Joe's: Coffee shop on campus, named after former Moody president Joseph Stowell III. Joe's is located on the upper level of the Alumni Student Center.

JSB: Junior/Senior Banquet. A formal banquet given by juniors in honor of the senior class during the spring semester.

Kesher: A student organization open to students with an interest in gaining a further understanding of Jewish culture and who would like to be involved in ministry opportunities to the Jewish community.

The “L”: Chicago’s elevated trains provide access from campus to most areas of the city as well as the near suburbs and Chicago’s two main airports.

Moody Campus Radio: A student-operated radio station, broadcast on campus and on the Internet at www.moodycampusradio.com.

MoodyCaster: Weekly announcements, updated daily online, contain important information and events on campus for students.

Moody Central: Located on the second floor of Culbertson Hall, Moody Central exists as a solutions-based service center for Moody Bible Institute students.

The Moody Standard: Biweekly student newspaper.

PCM: Practical Christian Ministry. Each student is required to have one PCM per semester, a weekly commitment of Christian service.

Plaza: The center area of Moody’s main campus, encircled by Fitzwater, Culbertson, Houghton, Crowell, and Smith Halls and the Alumni Student Center.

Puente: A student organization open to students who have an interest in gaining a further understanding of Hispanic culture and would like to be involved in ministry opportunities to the Hispanic community.

RA: Resident Assistant. A student placed on each floor to assist other students and to serve as a liaison between students and administration.

RS: Residence Supervisor. A member of the Residence Life staff who resides on campus and supervises RAs and residence hall life. There is always one RS on call, 24 hours a day. The RS is a good person to talk to if you are concerned about your son’s or daughter’s adjustment to life at Moody.

Female RSs: (312) 329-4203, 4356

Male RSs: (312) 329-2028, 2029

Jenkins Hall: (312) 329-2021

RACO: Residence Activities Council. Responsible for student body social activities.

SMF: Student Missions Fellowship. Responsible for the missions emphasis among the student body.

Smith Hall: Women’s residence hall which also houses Health Service, Counseling Services, and Event and Guest Services offices.

Solheim: Solheim Life Science and Urban Outreach Center. Moody’s physical education/community outreach facility houses a main and auxiliary gym, racquetball courts, weight and aerobic exercise rooms, swimming pool, and a jogging track. Located just outside are the Center’s tennis courts and soccer field.

SGA: Student Government Association. Serves as a liaison between students and administration.

Stu Dev: The Student Development department is devoted entirely to students and their needs. Led by the Vice President and Dean of Student Life, it includes the areas of Residence Life, Counseling Services, Student Programs, Health Service, Food Service, and Mail Services.

Sweeting: The George Sweeting Center for World Evangelization, named after former president Dr. George Sweeting, is Moody’s academic/learning resource center. The facility contains classrooms, faculty offices, the library, Education Technology Services, computer labs, and a communications center.

Tunnels: A system of underground passageways allowing students access to most buildings on the main campus.

The Vine: A women’s ministry focused on fostering authentic and Christ-centered community across campus through small groups and discipleship relationships.

As you consider your relationship with your college student, we've included a few of our thoughts, gathered from our experiences with parents and students. We pray that you will be encouraged in your new role!

TRANSITIONS

Understand that the first few weeks or months may be challenging for you and your student. Your student is experiencing a lot of changes in his or her life. Expect a period of adjustment. Be supportive.

COMMUNICATION

- Stay in touch with your student. Phone calls, emails, letters, care packages, and cards will remind your student that you're thinking about him or her.
- Affirm confidence in your student's potential. Avoid being too enthusiastic or too critical. Praise his or her accomplishments.
- Listen carefully to your student and the issues that he or she expresses to you.
- Be prepared for some major, controversial discussions.
- Keep your sense of humor with your student.

SENSITIVITY

- Consider your student's new schedule. The first week of school, mid-terms, and final exams are often very busy and can be stressful times during the semester.
- Visit your student, but please do not surprise him or her. Homework, jobs, and social activities tend to fill a student's schedule. Allow your student time to plan ahead. Keep in mind that time management challenges students.

FRIENDSHIPS

- Encourage your student to become involved in activities. Involvement will allow your student to grow academically and socially and help him or her identify with a smaller group on campus.
- Take comfort in knowing that formation of identity, independence, and intimacy are as much a part of college as academics.

- Don't compare your student to his or her siblings, friends, or others who are familiar to you.

DEVELOPMENT

- Don't be surprised if your student expresses an interest in changing majors. Your student will be exposed to a variety of academic areas and career possibilities, especially during the first year. As your student discovers new opportunities, his or her focus may change. Accept your student's choice of major. Remember that God is working in your student's life and preparing your student for the future.
- Talk about money with your student. Mutually understood budgets will help your student with spending and savings expectations. Make it clear if you are expecting your student to work part-time to help meet school costs.
- Don't make assumptions about breaks and where your student will spend them. Your student may wish to return home for breaks and vacations, or he or she may want to spend time with friends.
- Don't be surprised if your student expects greater freedom when he or she is at home. As a college student, your son or daughter will be accustomed to a certain amount of freedom. Your student may expect the same degree of independence when spending time at home. If you respect your student's expanded sense of personal freedom, he or she will feel more positive about spending time at home.

MISCELLANEOUS

If you have additional questions or concerns, please contact the Student Development office at (312) 329-4193 or studentdevelopment@moody.edu. We are happy to serve you and the needs of your student!

gift card/care package

Dear friend,

As a former student, I know the joy Moody students receive when loved ones send them reminders that they are in their prayers or thoughts regardless of the occasion: special days, hard weeks when studying goes into all hours of the night, and days when they just need an uplifting word.

While care packages are one option among many, we hope you will consider letting us partner with you to encourage your student with our services. The Food Service department currently offers two options to send something special to your student.

- First is our Food Service One Card, a gift card that works in all Moody Food Service locations. One favored spot is Joe's, our student-run coffee shop which offers a relaxing atmosphere for studying or breaks. We also have The Commons, our premier retail café where students can quickly grab freshly made grill options, pre-made sandwiches, or their desired snack.

Gift cards may be purchased in \$5 increments starting at \$10. Students may now load their campus fobs with gift card funds for quick and easy access without needing to carry another card. Cards can be recharged at any time at either location listed above with cash or credit card—even over the phone! To order, simply access our online gift card order form at www.moody.edu/special/giftcard.aspx.

- The second option is our Care Package. We have many assortments of goodies to choose from. Our department will prepare a personalized Care Package of your choice and notify your student—on the date you request—that there is a package for them in the Food Service office, saving you the time of shopping and mailing. To order a Care Package, simply fill out the website order form at www.moody.edu/special/carebasket.aspx.*

If you prefer to mail your order, complete the form on the next page and send it with your enclosed form of payment (check, money order, Visa, or MasterCard number).

Please plan ahead to make sure we are able to deliver on the date you request (online orders take approximately two days to process, and mailed orders take at least a week to arrive before processing).

All net proceeds benefit Moody Bible Institute.

Remember, students cherish things from home. I know I will never forget what my parents sent me, and I hope that I can help you do the same for your student. It is such a joy to serve them through their dining experiences. I look forward to serving them in any additional way I can.

Sincerely,



Rachel Campbell
Food Service Office Coordinator
(312) 329-4324

Gift Card/Care Package Order Form

Finals Packages (see other side for options)

**All students will be notified of their package the Wed. prior to finals week.
Finals packages must be ordered no later than the week prior to the notifications.
Packages will be waiting in the Food Service Office.**

Online orders can be made at www.moody.edu/special/carebasket.aspx

ONLY \$25 Per Package!

(Finals options on other side excluded)

All-Nighter Study Package

Mountain Dew (x2)
Apple Juice
Fruit Card* (2 pieces)
White Cheddar Popcorn
Planters Salted Peanuts
Cheetos Crunchy Corn Curls
Garden Salsa SunChips
Nutter Butter
Snickers
Nutrigrain Bar
Quaker Granola Bar
Snackwell Cookies



Athletic Trainer

Bottled Waters (x2)
CranApple Raspberry Juice
Vitamin Water
Strawberry Protein Bar
Kind Bar
Trail Mix Kashi Bar
Sweet 'N Salty Peanut Bar - Nature Valley
Chocolate Peanut Butter Protein Bar
Fruit Cards* (x3 = 6 pieces)



Chocolate Lover

Milk Carton Cards* (x2)
2 Hot Cocoa Packets
Twix
Hershey Bar
Milky Way
Kit Kat
Snickers
Reese's Peanut Butter Cups
M&Ms with Peanuts
Chocolate Rice Krispy Treats
Chips Ahoy Cookies
Double Chocolate Protein Bar



Birthday Package

Cherry Coke
Barq's Root Beer
FUZE Iced Tea
Baked Lays
SunChips: Garden Salsa
BBQ Kettle Chips
Poptarts
Pretzels
Skittles
Starburst
Rice Krispy Treats
Oreo Cookies
Hershey Bar



Sweet 'N Salty

CranGrape Juice
Mr. Pibb
Classic Coca Cola
Fritos
Pretzels
Sea Salt Kettle Chips
Planters Salted Peanuts
Planters Trail Mix
Snickers
Honey Almond Flax Kashi Bar
M&Ms
Reese's Peanut Butter Cups
PayDay



Cup of "Joe's" (No Substitutes)

Moody Logo Mug filled with
\$10 gift card to Joe's
2 Hot Cocoa Packets
Snackwell Cookies
Fig Newton Bar



Get Better Soon Package

Bottled Water (x2)
Ginger Ale
Vitamin Water
Apple Sauce
Mints
Fruit Cards* (x3 = 6 pieces)
Bonus Feel Better Gift (not same as pictured)



Gluten Free

Sprite
Vitamin Water
Orange Juice
Skittles
Starburst
M&Ms
Peanut M&Ms
Sweet 'N Salty Peanut Bar - Nature Valley
Rice Krispy Treats
Fruit Card* (2 pieces)
Fritos
White Cheddar Cheese Popcorn
Nacho Cheese Doritos



Additional Substitutes

Diet Coke
Caffeine Free, Diet Coca Cola
Coke Zero (Cherry or Regular)
Pepsi (Diet or Regular)
Dr. Pepper (Diet, Cherry, 10, or Regular)
Grapefruit Juice
Belvita Breakfast Biscuits
SunChips (Harvest Cheddar or Original)
Nuttty Buddy Wafer Bar
Planters Trail Mix (Fruit & Nut or Cajun)
Poptarts - (Strawberry, Blueberry, Choc. Chip, or Brown Sugar Cinnamon)

Substitutions & Create Your Own Package:

Want one package, but not everything in it? Substitutions for any of the above mentioned items are allowed (except for the Cup of "Joe's"). Please substitute drinks with drinks and snacks with snacks. You can even create an entirely new package! When creating your own please choose 3 drinks and 10 snacks listed above.

*To ensure the freshness of the product, a fresh fruit card or milk carton card is used. Students can use The Commons to pick out their own item at their convenience.

Parent's full name: _____
 Street address: _____
 City: _____ State: _____ Zip: _____
 Phone w/area code: _____
 Parent's email address: _____
 Student's name: _____
 Best way to notify student: Text Phone Call E-mail Note through CPO
 Desired date to notify student: _____ Student CPO # _____
 Student email address: _____
 Student phone # _____
 Enclosed check or money order payable to: Moody Bible Institute
 Credit card: Visa MasterCard
 Credit card number: _____
 Exp. date ____/____/____ Signature: _____

Please check the option you are ordering:

- Gift Card: Amount desired (starting at \$10) _____
- All-Nighter Study Package (\$25)
- Athletic Trainer (\$25)
- Chocolate Lover (\$25)
- Birthday Package (\$25)
- Sweet N Salty (\$25)
- Cup of "Joe's" (\$25)
- Get Better Soon (\$25)
- Gluten Free (\$25)
- Create Your Own (\$25)
- Standard Finals Package (\$30)
- Super Finals Package (\$40)
- Mega Study Session (\$50)

Include your own card or write a message here to be included: _____

Please list substitutions or desired contents here:

Send to: Food Service Office
 Moody Bible Institute
 820 N. LaSalle Blvd.
 Chicago, IL 60610

Gift Card/Care Package Order Form

Finals Packages

Finals Package

Includes:
3 bottled beverages
10 snack items
An assortment
of stress reliever
toys/games

\$30

Super Finals Package

Includes:
5 bottled beverages
15 snack items
An assortment
of stress reliever
toys/games

\$40

Mega Study Session Package

Includes:
5 bottled beverages
15 snack items
An assortment
of stress reliever
toys/games
**\$15 gift card to Joe's/
The Commons**

\$50